

国立大学法人 豊橋技術科学大学
Toyohashi University of Technology
1-1 Hibarigaoka, Tempaku, Toyohashi, Aichi,
441-8580, JAPAN

Welcome to Toyohashi University of Technology

Message from the President



Toyohashi University of Technology offers a wide-ranging engineering curriculum to students from both technical colleges and conventional high schools. Most students undertake a four-year program, starting at the undergraduate level and then proceeding directly into a master's program.

Of course, some of these students go on to a doctoral program to conduct further research.

We are a relatively young and dynamic research-oriented institution with highly motivated students and faculty.

We have excellent research facilities, including the Research Institute for Science & Technology Innovation, which was newly established this year, integrating EIIRIS and the Robotics Research Center, which has obtained an extremely high reputation in Japan along with other research centers on our campus.

On top of this, we also have an overseas campus on Penang Island, Malaysia, where Japanese students and Asian students meet together to study and engage in practical training.

Toyohashi is a comfortable and convenient place to live. It is located only about 90 minutes from Tokyo and 50 minutes from Nagoya. It enjoys a mild climate with many sunny days throughout the year.

Our students can enjoy an active campus life, utilizing various facilities for extra-curricular activities, such as sports fields, a swimming pool, a weight training room and a gymnasium.

The campus is surrounded by historic sites, mountains and beaches. It is an excellent environment for living and creative thinking.

We currently have 167 foreign students from 26 countries. Not only do we offer all sorts of engineering-oriented subjects, but we also have excellent Japanese language programs for international students at the undergraduate and graduate level.

We welcome ambitious and motivated students to Toyohashi University of Technology.

大西 隆

Dr. Takashi Onishi
President

TUT in Brief

Founded in **1976**

ACADEMIC
DEPARTMENTS: **5**

STUDENTS: **2,240**

- Undergraduate, **1,215**

- Graduate, **1,022**

- International students, **167**
(8% of the total student population)

FACULTY: **241**

Partner institutions: **64**
worldwide in **22** countries

CAMPUS SIZE:
355,606 m² (88 acres)
as of May 2015



University seal



Communication mark

Why study at TUT?

Here are some good reasons to choose TUT ...

Top national university dedicated to technological sciences

- Among an elite group of 22 universities selected for the Japanese government-funded program, the Program for Promoting the Enhancement of Research Universities.
- Among an elite group of 30 universities selected for the Japanese government-funded program, Program for Leading Graduate Schools.
- Among an elite group of 37 universities selected for the Japanese government-funded program, Top Global University Project, a project created for the purpose of leading the internationalization of higher education in Japan.
- Only TUT and 13 other universities qualified for all three of these programs under standards set by the Japanese government.

Upper-tier rankings* in Japanese universities

- Internship participation ratio (1st)
- Robotics contest ranking (1995-2014) (1st)
- Higher campus facilities per student (3rd)
- Continuation on to graduate school ratio (7th)
- Higher research grant money per faculty (10th)
- Higher publications per faculty (14th)
- Lower student-faculty ratio (21st)

* Source: Asahi Newspaper rankings of 762 universities in Japan, 2016

Over 1,000 graduate students excelling in technology

- Most TUT students have been distinguished students studying engineering, technology and science from 16 years of age within Japan's unique, "Kosen" technology education system.

Top-class environment for education and research

- TUT is the only university in the world that hosts an entire process facility dedicated to semiconductor device prototyping for education and cutting-edge research. A world-class interdisciplinary research center and other innovative centers are located on campus.
- There are various international student support programs for living in Japan and academic skills development.
- Main campus is located in the City of Toyohashi in central Japan. The overseas education base for industrial internships and study abroad programs is located in Penang, Malaysia.

Affordable cost of studying and living in Toyohashi

- Inexpensive tuition is the same for Japanese and international students.
- Japanese government-backed (Monbukagakuso) scholarships and more than 160 privately-funded scholarships are available.
- With affordable on-campus and off-campus accommodations and a low cost of living, Toyohashi is a relatively inexpensive place to study.

Education and Research

Mechanical Engineering

- Mechanical Systems Design Course
- Materials and Manufacturing Course
- System Control and Robotics Course
- Environment and Energy Course

Student message

I came from the University of Stuttgart, Germany, which has an agreement for a double degree master's program with TUT. I have been studying engineering cybernetics, which mostly involves control theory, modeling mechanical systems and robotics. It is well known that Japan is highly advanced in robotics and I heard that TUT has excellent research laboratories. Studying at TUT is a great opportunity for me. Everything here is well organized and the people are very nice. If you have any problems you can ask the staff from the international affairs division, they won't hesitate to help you. When else, other than your time as a student, can you stay over a year in another country? It will be an experience you will never forget in your life.



Schaeffle Tobias Rainer from Germany
International Master's Double Degree Program

► <http://www.tut.ac.jp/english/introduction/department.html>

Environmental and Life Sciences

- Sustainable Development Course
- Life and Materials Science Course

Student message

Studying environmental and life sciences at TUT is a perfect opportunity to learn what I have always wanted to pursue. My research and study is about the isolation and characterization of acidophilic nitrifying bacteria from acidophilic nitrifying sequencing batch reactors. The lecturers are not only friendly but also have experience in industry, so that we can learn from their amazing experience right away. Furthermore, there are so many great facilities which help improve our academic skills and help with our professional progress. I have gained a lot of knowledge and experience in my university life. I will use this know-how in my home country for the sake of the people and the environment.



Surya Giri from Nepal
International Master's Degree Program

Electrical and Electronic Information Engineering

- Electronic Materials Course
- Electrical Systems Course
- Integrated Electronics Course
- Information and Communication System Course

Student message

If you want to become a highly-skilled engineer and learn a great deal about engineering, I think studying at TUT is the best choice because TUT is a top-level university in Japan with high-tech facilities. I'm also glad to be here because I can learn a lot of things and form lasting relationships with my Japanese friends. They are really kind and if I have any trouble--especially trouble speaking Japanese--they will help me. In the future, I would like to pursue my studies in master's course here and after that I will look for the opportunity to work as an engineer in Japan.



Nur Liyana binti Tajudin from Malaysia
Undergraduate Program

Architecture and Civil Engineering

- Architecture and Building Science Course
- Civil and Environmental Engineering Course

Student message

Toyohashi University of Technology is famous for its sophisticated research in many disciplines. Here, I am studying about hydrodynamic and ecological modeling in the Water Environmental Engineering Laboratory. Our laboratory is very concerned about water quality issues in Japan and South-East Asia, especially Indonesia. In the future, I wish to apply this knowledge in my country to support the decision makers in identifying the scope of environmental problems and further planning the best management practices. Student life at TUT is not only about study and research, but also about having fun. TUT always holds field trips, sport tournaments and cultural events every year. As a person who loves culture and history, I had a great experience taking part in the Kyoto Trip, where we went to several historical places around Kyoto and enjoyed the beauty of the city.



Teuku Mahlii from Indonesia
International Doctoral Degree Program

Computer Science and Engineering

- Computer and Information Science Course
- Information and Systems Science Course

Student message

I am glad to be a member of the ICD Lab (Interaction and Communication Design Laboratory) where research into human and robot interaction (HRI) is conducted. I want to improve myself by studying creative robots and contribute to this field since I believe that the robots will be an integral part of our lives in the future. Apart from the studies, TUT provides various opportunities to learn about and appreciate Japanese culture and its natural beauty through student clubs and international activities. The international student club "CALL" arranges many parties and activities throughout the year. Through these activities I could make great friends from many different countries.



Nihan Karatas from Turkey
International Doctoral Degree Program

Institute of Liberal Arts and Science

This department is responsible for the liberal arts (humanities, social sciences and natural sciences), physical and health education, and foreign languages. It aims to provide an indispensable education and cultivate engineers who will be active on the international stage.



Education and Research

▶ <http://www.tut.ac.jp/english/introduction/institutes.html>

Electronics-Inspired Interdisciplinary Research Institute (EIIRIS)

EIIRIS was established in 2010 with the aim of being an interdisciplinary research institute. With the cooperation from researchers and students in multiple fields, this institute is engaged in a myriad of research projects, including cutting-edge neuroscience studies, research using magnetic particles, investigations of various parasitic microorganisms, studies on lipids, robotics engineering projects, and research on eye retinas.



Venture Business Laboratory

The LSI Factory is one of the top facilities in the world for engaging in all processes related to integrated semiconductor circuits, from design to manufacturing and operational checks.



Center for Human-Robot Symbiosis Research

With the cooperation of local medical facilities and corporations, the Center for Human-Robot Symbiosis Research aims to contribute to the community through the constructive implementation of technological developments in the field of robotics. This research center is promoting projects that are working on the development of rehabilitation robots, nursing robots, and intelligent nursing stations as well as the construction of a robotic campus where service robots are distributed throughout the campus.



Joint Laboratory with world-leading institutions

Prof. Shimojo (Caltech)-TUT International Collaborative Research Laboratory

– Mind & Brain Laboratory for Perceptual and Cognitive Processing –

This laboratory is blazing trails in “the science of the mind” that lies at the foundation of a deeper understanding of humankind and society by elucidating the underlying workings of the brain and how it serves as the foundation for human reason, mutual understanding, action, and perception through neurocognitive approaches such as non-invasive brain function measurement techniques.

AIST-TUT Advanced Sensor Collaborative Research Laboratory

Advanced Sensor Devices and Fabrication Process Laboratory with Minimal Manufacturing Technology

Together with the National Institute of Advanced Industrial Science and Technology and private corporations, this laboratory is performing advanced sensor research that fuses TUT's advanced sensing device research with the idea of creating a systematic minimal manufacturing system that can create many kinds of devices in small quantities, where and when they are needed in the quantities needed.

Other research centers

- Research Center for Agrotechnology and Biotechnology
- Research Center for Future Vehicle City
- Research Center for Collaborative Area Risk Management (CARM)
- Information and Media Center
- Cooperative Research Facility Center



Academic Programs

Undergraduate program

- Lectures in Japanese
- Admission as a 1st-year or 3rd-year student is possible

Undergraduate twinning programs:

Hanoi University of Technology (Vietnam) University of Danang (Vietnam)
Mongolian University of Science and Technology (Mongolia) Malaysia Japan Higher Education Program (Malaysia)

- Lectures in Japanese
- Admission as a 3rd-year student

Graduate program (master's degree / doctoral degree)

- Lectures in Japanese

International graduate program (master's degree / doctoral degree)

- Lectures in English

International master's degree twinning programs with:

Universitas Hasanuddin (Indonesia) Institut Teknologi Bandung (Indonesia)
Ho Chi Minh City University of Technology (Vietnam) Northeastern University (China)

- Lectures in English

International master's double degree program with:

University of Stuttgart (Germany)

- Lectures in English

Global Technology Architects Course starts from April 2017

- This comprehensive undergraduate-master's program is designed for Japanese and international students who desire international careers.
- Admission as a 3rd-year undergraduate student: Enrollment in April 2017 / Entrance exam in June 2016
- Admission as a 1st-year undergraduate student: Enrollment in April 2018 / Entrance exam in September 2017 and January 2018

“Global Technology Architects” refers to creative engineers and researchers with a high level of planning and design capabilities. The GAC aims to develop engineers and researchers with such capabilities.

▶ <http://sgu.tut.ac.jp/eng/>

Research students

Research students do their research under the guidance of an academic supervisor without the aim of earning credits or obtaining degrees.

Visiting students

(Special research students/Special audit students)

Visiting students do their research or study while they are continuing their study in home university. There are two types of visiting students: “special research students” aim to do research and “special audit students” aim to earn credits.

Programs		Language			Admission	
		JPN	ENG	Bilingual	Apr.	Oct.
Undergraduate program		✓			✓	
Graduate program	master's degree	✓			✓	
	doctoral degree	✓			✓	✓
International graduate program	master's degree		✓			✓
	doctoral degree		✓			✓
International master's degree twinning programs			✓			✓
International master's double degree program			✓			✓
Global Technology Architects Course				✓	✓	

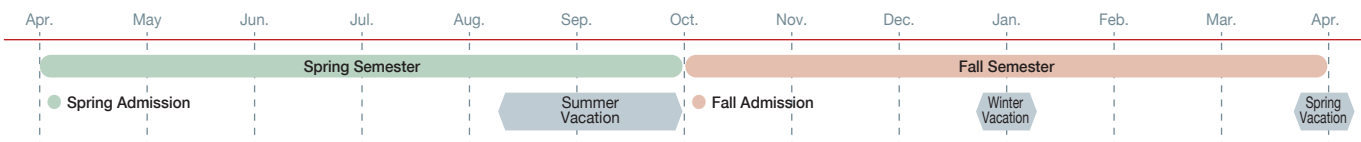

How to apply

Undergraduate program

- 1 Refer to the application guide**
Visit <http://www.tut.ac.jp/exam/collect.html> to find the application guide.
- 2 Check entry requirements**
Applicants shall comply with all the requirements.
- 3 Apply for admission**
Registration via the Internet is necessary before submitting the required documents.

Graduate program / International graduate program

- 1 Find a supervisor**
Applicants for the master's program (offered in Japanese) do not need approval from a supervisor.
- 2 Refer to the application guide**
Visit <http://www.tut.ac.jp/exam/collect.html> (graduate program) or <http://www.tut.ac.jp/english/international/> (international graduate program) to find the application guide.
- 3 Check entry requirements**
Applicants shall comply with all the requirements.
- 4 Apply for admission**
Registration via the Internet is necessary before submitting the required documents for the master's program (graduate program).

Twinning or double degree programs

- 1 Verify your status**
- 2 Refer to the application guide**
Contact the admissions office at your university to find the application guide for the undergraduate twinning program.
Visit <http://www.tut.ac.jp/english/international/> to find the application guide for the international master's twinning or double degree program.
- 3 Contact the admissions office at your university for the program**
- 4 Check entry requirements**
Applicants shall comply with all the requirements.
- 5 Apply for admission**

Research students

- 1 Find a supervisor**
- 2 Refer to the application guide**
Visit <http://www.tut.ac.jp/english/international/research.html> to find the application guide.
- 3 Check entry requirements**
Applicants shall comply with all the requirements.
- 4 Prepare your research plan**
- 5 Apply for admission**

Visiting students (special research students/ special audit students)

- 1 Find a supervisor or a contact faculty member**
- 2 Refer to the application guide**
Visit http://www.tut.ac.jp/english/international/short_term.html to find the application guide.
- 3 Check entry requirements**
Applicants shall comply with all the requirements.
- 4 Apply for enrollment**

How to select a course

Explore our departments in this guide, or visit:

- ▶ <http://www.tut.ac.jp/university/subject.html> (Japanese) or
- ▶ <http://www.tut.ac.jp/english/introduction/department.html> (English)

How to find a supervisor

To get approval from a prospective supervisor, visit:

- Department information ▶ <http://www.tut.ac.jp/english/introduction/department.html>
 - Faculty members list ▶ <http://www.tut.ac.jp/english/schools/faculty/>
 - Key word search ▶ http://www.tut.ac.jp/english/research/key_words_search.html
- Proceed to make contact with the faculty member on your own.

Inquiries about the admission process

- Entrance Examination Division Email: nyushi@office.tut.ac.jp TEL: +81-532-44-6527
(for undergraduate program/ graduate program/ international graduate program/ twinning program/ double degree program/Global Technology Architects Course)
- International Affairs Division Email: ryugaku@office.tut.ac.jp TEL: +81-532-44-6577
(for research students/ visiting students)

Student life

Student message

I am currently focused on courses for my major, such as organic synthetic chemistry and polymer science. In the future, I would like to perform research in the cosmetics field, which is why I want to join a laboratory in my fourth year and perform technical research. Outside of class, I usually review my class notes and write reports. I often use the university library since it is so convenient, being open 24 hours a day. Apart from that, I have found the support for international students to be a huge help. For example, I get information on events and scholarships, among other things.

Also, I have joined the Table Tennis Club. I was not very good at first, but I have been enjoying learning from my friends. On Sundays, I practice badminton with a club for Vietnamese students. It is important to interact with friends from other countries, including Japan, but I also find it important to have time to talk with other students from my own country.

I imagine students who are about to take the entrance exam feel anxious about their studies and their future, but I hope that they do their best so that they do not have any regrets no matter what university they get accepted to. Of course, I hope to meet everyone who comes to Toyohashi University of Technology. Let us never forget our dreams as we look towards the future.



Nguyen Thi Phuong Thao
from Vietnam
Undergraduate Program
Environmental and Life Sciences



Schedule (day) & Timetable (week)

	6:00	7:00	8:00	9:00	10:00	11:00	12:00	13:00	14:00	15:00	16:00	17:00	18:00	19:00	20:00	21:00	22:00	23:00	24:00	1:00	2:00
Monday	Wake-up			School										Free time					Going to bed		
Tuesday	Wake-up			School										Club activities					Going to bed		
Wednesday	Wake-up			School										Free time					Going to bed		
Thursday	Wake-up			School										Club activities					Going to bed		
Friday	Wake-up			School										Free time					Going to bed		
Saturday	Wake-up			Part time job										Phone with family					Going to bed		
Sunday	Wake-up			Part time job									Badminton						Going to bed		

Events

There are many events where international students can interact with Japanese students and members of the local community. We are sure that these events and activities will leave international students with lasting memories:



International Exchange Day



University Festival



Study Trip



Open Campus

► <http://ignite.tut.ac.jp/cir/english/event/>

Club activities

Join our club activities! More than 51 official clubs

Sports:

baseball, soccer, tennis, surfing, triathlon, kyudo (Japanese archery), kendo (Japanese fencing), and more

Culture and Hobbies:

robocon (robot contest), tea ceremony, international exchange, jazz band, and more

Students' Union: Student council and more



► http://www.tut.ac.jp/english/student_life/campuslife.html

Support and services

Tutor system

Newly-arrived international students are assigned tutors to facilitate their new lives in Japan. Tutor support is mainly for study and research and lasts for at least 1 year.

► <http://ignite.tut.ac.jp/cir/english/students/tutor.html>

Counseling support

There are faculty members who can speak both English and Japanese at the Center for International Relations. They provide counseling and advising services for problems related to academics and everyday life. Counselors and doctors are also available to provide counseling and advising services for academics, life or health.

► <http://ignite.tut.ac.jp/cir/english/students/consultation.html>

Medical and health care

Our school nurse is on call daily at the health care center in case of sickness or medical emergency. A school doctor is also available to give students advice and guidance about their physical or mental well-being.

Insurance

All international students are required to join the national health insurance in Japan. Once insured, you pay only 30% of any incurred medical or dental costs. Furthermore, our university takes out insurance for all regular students in case of accidental injury occurring during classes, such as physical education as well as experiments or extracurricular activities.

Japanese language education

The Center for International Relations offers three Japanese language courses:

-Japanese Intensive Language Course I

-Japanese Intensive Language Course II

-Basic Japanese Classes

► <http://ignite.tut.ac.jp/cir/english/students/program/>



Accommodations

On campus

Student dormitory



-595 rooms are available for both international and Japanese students.

-Each room is equipped with a bed, desk, chair, bookshelf, air conditioner/heater and LAN socket. Some rooms have their own kitchen, toilet, shower and sink, while others share these facilities with other rooms.

Dormitory A・B・C・D(400 rooms)	Male undergraduate students	¥7,000 / month
Dormitory E (99 rooms)	Male graduate students	¥11,000 / month
Dormitory F (96 rooms)	Female students Male graduate students	¥20,000 / month

► http://www.tut.ac.jp/english/student_life/ua.html

International house



-There are 54 rooms mainly set aside for newly arrived international students.

-Each room is equipped with a desk, chair, bed, bookshelf, refrigerator, wardrobe and air conditioner/heater. Some rooms have their own kitchen, toilet, shower and sink, while others share these facilities with other rooms.

Single room	¥5,900/month
Couple room	¥11,900/month
Family room	¥14,200/month

► http://www.tut.ac.jp/english/student_life/ua.html

Multicultural Boarding House

New global-oriented accommodation to be built

-Shared-house style accommodation consisting of 180 rooms for international and Japanese students enrolled in the Global Technology Architects Course

-English intended as a common language spoken in the house

-Permanently stationed house master/resident assistants

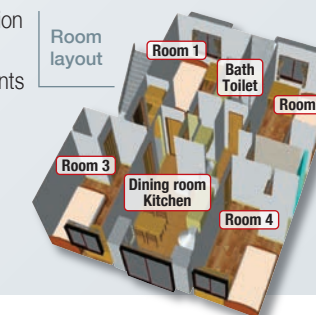

Off campus

Private apartments around campus

Most of international students live in private apartments. The rent of a private apartment varies according to the location and size.

Financial information

Academic fees

	Application Fee	Enrollment Fee	Tuition
Undergraduate students	17,000 yen	282,000 yen	535,800 yen/ year
Graduate students	30,000 yen	282,000 yen	535,800 yen/ year
Research students	9,800 yen	84,600 yen	356,400 yen/ year (29,700 yen/ month)
Special research students	Exempt	Exempt	356,400 yen/ year (29,700 yen/ month)
Special audit students	Exempt	Exempt	14,800 yen/ credit

In special cases where regular students have financial difficulties in paying tuition but have shown excellent academic achievement, the university may waive half or all of the tuition fee. Regular students enrolled in April can also apply for enrollment fee waiver.

According to the agreements with have with our partner universities, some students may be eligible to apply for a waiver of tuition and other academic fees for certain academic programs.

Special research students and special audit students coming from our partner universities are exempted from the tuition fee.

Scholarships

80% of our current international students are supported by scholarship; this ratio is significantly higher than other universities. Applicants may be eligible to apply for a Japanese Government (MEXT) scholarship, JICA scholarship or an Aichi scholarship. Furthermore, there are many privately-funded scholarships available for international students after enrollment in the university. Nowadays, more and more international students are obtaining scholarships from entities within their own countries.

Scholarships / Financial Support

► <http://www.tut.ac.jp/english/international/scholarship.html>

Living in Toyohashi

The cost of living in Toyohashi is much lower than in other bigger cities. In particular, rental prices for accommodations in Toyohashi are approximately half that of Tokyo.

For your reference, here are some of the costs associated with living and studying in Toyohashi.

*Please be advised that this is an estimate only; costs vary from one individual to another.

*The table does not include clothing and medical expenses. You will also have to pay tuition and other associated academic costs.

*The Immigration Bureau of Japan has financial requirements you must meet in order to receive a student visa.

Schedule of Admission & Visa

► http://www.tut.ac.jp/english/international/schedule_of_admission_visa.html

Average Monthly Cost	
Books and materials	10,000 yen
Accommodation	Dormitory: 7,000 yen- 20,000 yen International House: 5,900 yen – 14,200 yen Private apartment: 15,000 yen- 40,000 yen Deposit, Fees: depends on property
Board and Living expenses	40,000 yen
Utility (Electricity, Gas, Water)	15,000 yen
Transportation	10,000 yen
Cell Phone	10,000 yen
National Health Insurance	1,500 yen
Others	10,000 yen
Total	102,400 yen~



Careers

Graduates from Toyohashi University of Technology are active all over the world as “practical and leading engineers”

Through a unified undergraduate to graduate education, TUT trains advanced engineers equipped with the outstanding skills in technological development needed to drive industry in Japan and the world.

All fourth-year undergraduate students undergo at least a 2-month internship in order to learn how to apply techniques and theories and to become accustomed to life in an actual work environment. With these practical skills, **58%** of international students go on to our graduate program.

We provide active employment support for students, such as career guidance, company information sessions, and employment lectures.

After the master's degree program, **15%** of international students go on to our doctoral degree program. **45%** of TUT graduates gain employment immediately after graduation, 36% of them find work in Japan, 9% work abroad.

After the doctoral degree program, more than **50%** of Ph.D. international students gain employment immediately after graduation, 20% of them find work in Japan, 32% work abroad.

After graduating from TUT, our alumni move on to active careers in corporations and universities all over the world, including Japanese corporations.

Where international graduates are employed

Companies

Canon Opto (Malaysia) Sdn Bhd
Central Nippon Expressway Company Limited
Daihatsu Motor Co., Ltd.
Fujitsu Limited
Fuji Xerox Co., Ltd.
Hitachi Chemical Company, Ltd.
KDDI Thailand Ltd.
Konica Minolta, Inc.
LG Electronics Inc.
NEC Corporation
NGK Spark Plug Co., Ltd.
NH Foods Ltd.
Nissan Motor Co., Ltd.
OSG Corporation
Panasonic Corporation
Renesas Electronics Corporation
Sumitomo Chemical Company, Limited
Samsung Electronics Co., Ltd.
Suzuki Motor Corporation
Toshiba Corporation
Toyota Motor Corporation
Yamaha Electronics Manufacturing
Yuraku Confectionery Co., Ltd.
and more



Education or research institutions

Bandung Institute of Technology
China Academy of Space Technology
Hanoi University of Science and Technology
Ho Chi Minh City University of Technology
Lampung University
Marshall University
Mongolian University of Science and Technology
Nanyang Technological University, Singapore
National University of Laos
Tanta University
The Institute of Metal Research, Chinese Academy of Sciences
University of São Paulo
University of Science Malaysia
University of Technology Malaysia
University of the Philippines
University of Waterloo

Kanagawa University
Kyoto University
The University of Tokyo
Tohoku University
Toyohashi University of Technology
and more



Graduate message

After graduating from TUT (Master's Program of Mechanical Engineering in 2015), I started to work at NGK Spark Plug Co., Ltd.. As a quality control engineer, I've been given the task of educating and training employees on how to improve and maintain the quality of their work. I also audit and inspect the plant to make sure that it is up to standards. I decided to work at NGK because I think I can contribute so much to this company with the skills that I acquired at TUT. I find my work rewarding when I do something new and am given the trust to do something that is important and worthwhile for the company. I will do my best to be a trusted and beneficial engineer to the world.



Aliff bin Mohd Aminuddin from Malaysia
NGK Spark Plug Co., Ltd. (日本特殊陶業株式会社)
Engineer

Location



Toyohashi City is located in the southeastern corner of Aichi Prefecture, and is both the cultural and industrial center of the East-Mikawa area.

Aichi is centrally located on the main Japanese island of Honshu, and is a setting where many feudal warlords have played major roles throughout history. In modern times, many companies are headquartered in Aichi, including Toyota Motor Corporation, Nippon Sharyo (railway rolling stock manufacturer) and Noritake (tableware manufacturer).

As one of Japan's 'core cities', Toyohashi has everything you'd expect to find in a major city, but it maintains the friendliness and love of Japanese tradition that bigger cities often forget.

Toyohashi has a mild climate, a low cost of living and is within easy reach of Nagoya, Tokyo, Osaka, Kyoto and Kobe by Shinkansen bullet train.

Toyohashi also has a wonderful natural environment, surrounded by the sea and mountains. This natural bounty means that there are many interesting places to visit.

The vast expanse of the Pacific Ocean is only a short bicycle ride away to the south of Toyohashi University of Technology' campus. There you will find Japan's longest beach, Omote-hama. This beach is popular for a variety of activities such as surfing, fishing and picnicking, and is also a famous spawning site for the loggerhead sea turtle. The north of the city is bordered by Mt. Ishimaki, and the hills to the east are home to popular attractions like the Toyohashi Nature Walk and Imo Bog. The powerful Toyo River flows through the city, blending with the surrounding greenery to create a beautiful landscape.

City data

Population: 373,086

Area: 261.86 km²

Population density: 1,425/km²

Average temperature: 16.1 °C

Hottest month: Aug., average high 31 °C

Coldest month: Feb., average high 10 °C

Total cabbage yield: 69,200 t

Volume of automobile exports: 824,027

Source: Toyohashi City website



Yoshida Castle



Ikobe Beach



Toyohashi City area



Tezutsu Hanabi
(Arm-held Fireworks)



Oni Matsuri
(Ogre Festival)



Toyohashi Museum of
Natural History

Contact and Access

Toyohashi campus



Toyohashi University of Technology
International Affairs Division

**1-1 Hibarigaoka, Tempaku, Toyohashi, Aichi,
441-8580 JAPAN**

E-mail: ryugaku@office.tut.ac.jp

Phone: +81-532-44-6577

Fax: +81-532-44-6557

From Chubu International Airport to Toyohashi Station

Take any Meitetsu train from the airport and change trains at the stop "Jingu-mae" to a Limited Express or Rapid Limited Express train bound for Toyohashi. It takes about 20-40 minutes (depending on train) from the Airport to Jingu-mae, and about 50 minutes from Jingu-mae to Toyohashi.

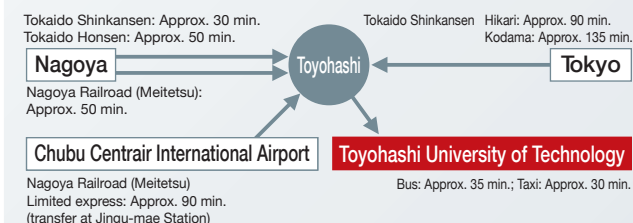

From Toyohashi station to the campus

The Toyotetsu bus runs from Toyohashi Station to the campus every 10-20 minutes from 7am to 8pm. Take a bus (34, 35, 36, or 37) with destination named "Gikadai-mae," "Re-Spa Toyohashi," or "Fukushi-mura" from bus stop No. 2 at Toyohashi station, east exit.

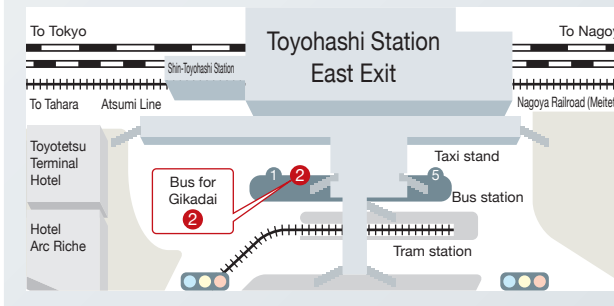

Penang campus



TUT-USM Penang

3 Cantonment Road, 10350 Penang, MALAYSIA

Phone: +604-226-6242 or +602-226-6252

Fax: +602-226-5755



Finding out more

TUT official web site

► <http://www.tut.ac.jp/english/>



Video Introduction

► <http://www.tut.ac.jp/english/introduction/video.html>

Center for International Relations

► <http://ignite.tut.ac.jp/cir/english/>



Top Global University Project web site

► <http://sgu.tut.ac.jp/eng/>

TUT Research: online magazine of research and international topics

► <http://www.tut.ac.jp/english/newsletter/>

